

L65B

LETTER ID: AEK

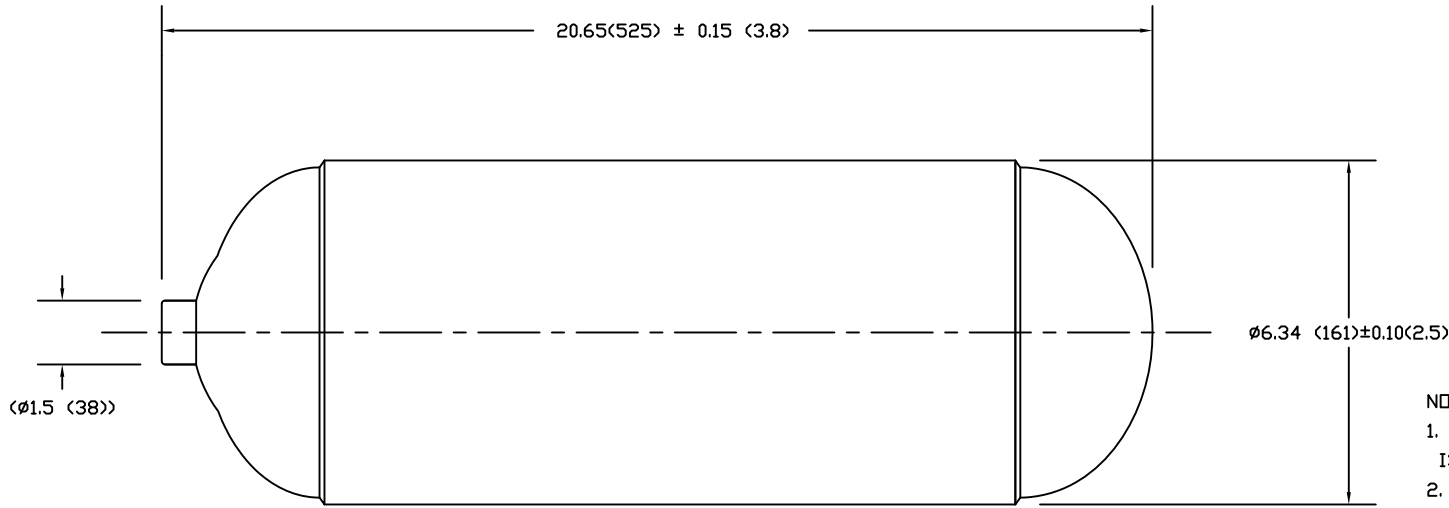

NOTES:

1. CYLINDER TO BE MANUFACTURED IN ACCORDANCE WITH ISO 11119-2 SPECIFICATION.
2. ALL DIMENSIONS SHOWN APPLY IN THE UNPRESSURIZED STATE AFTER THE TEST PRESSURE.
3. LINER MATERIAL: 6061-T6 ALUMINUM.
4. COMPOSITE MATERIAL: CARBON AND S-2 GLASS WITH EPOXY RESIN.
5. REFER TO THE L65B SCD'S FOR THE EXTERIOR DETAILS OF THE SPECIFIC CUSTOMER.
6. THE OUT-OF-ROUNDNESS OF THE CYLINDER SHALL NOT EXCEED 3% OF THE MEAN CYLINDER DIAMETER.
7. THE MAXIMUM DEVIATION OF THE CYLINDER FROM A STRAIGHT LINE SHALL NOT EXCEED 0.236 IN. (6 MM) PER 39.37 IN. (1 METRE) OF LENGTH.

M18 x 1.5 TOL. CLASS 6H

1. MINOR DIA. 16.676 - 16.376 MM
2. PITCH DIA. 17.216 - 17.026 MM
3. MAJOR DIA. 18.000 MM MIN.
4. MINIMUM NUMBER OF THREADS: 13

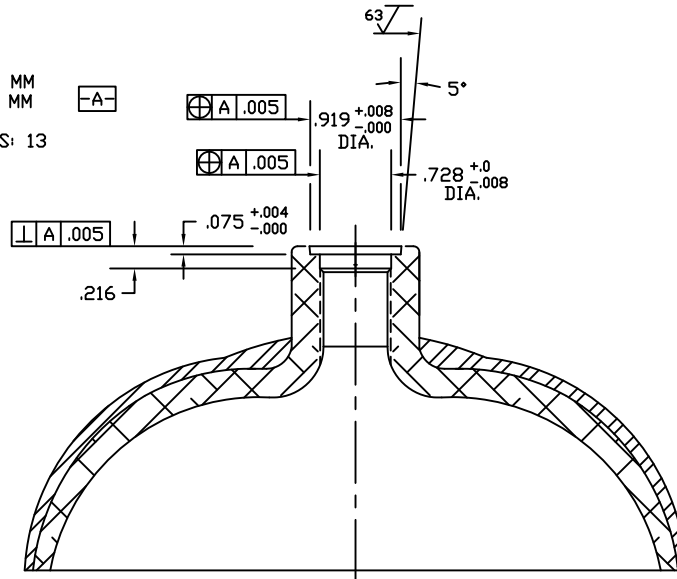

CYLINDER DATA

CYLINDER WEIGHT	9.7 LB (4.4 KG) MAX
WATER VOLUME	418 CU-IN (6.8 LITER) MIN.
SERVICE PRESSURE	4350 PSI (300 BAR).
TEST PRESSURE	6525 PSI (450 BAR).
MIN. BURST PRESS.	13050 PSI (900 BAR).
DESIGN LIFE	30 YEARS
VALVE TORQUE (MAX.)	AS PER EN ISO 13341



LUXFER GAS CYLINDERS

COMPOSITE CYLINDER DIVISION

Riverside, CA

DATE 05-12-08	ANGULAR ± 1° FRACTIONAL ± 1/16 DECIMAL .X .XX .XXX ±.1 ±.03 ±.005	125 FINISH UNLESS NOTED	COMPUTER FILE NAME L65B.DWG	SIZE C
DRAWN BY R. GARCIA	PART NAME & NUMBER 6.8 L CARBON LIFE SUPP CYLINDER			
APPROVED	SCALE NONE	CAGE CODE 59450	DRAWING NUMBER L65B	REV. NC

NC	Original	RG	05-12-08
REF.	CHANGE	BY	DATE

SHEET 1 OF 1